

FOUNDATION PLAN

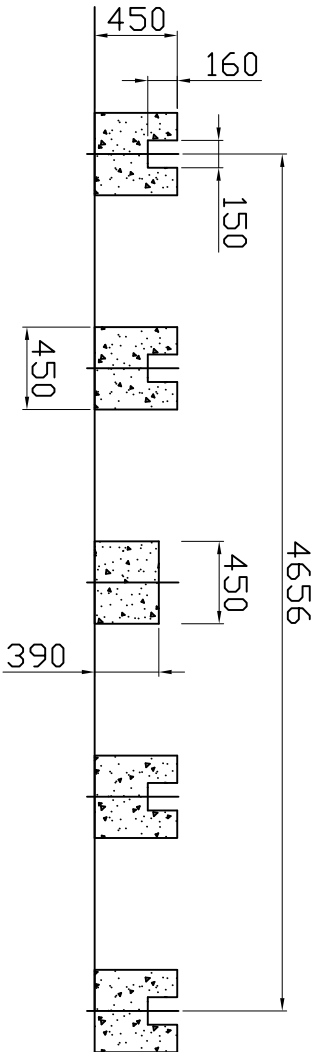

ELEVATION

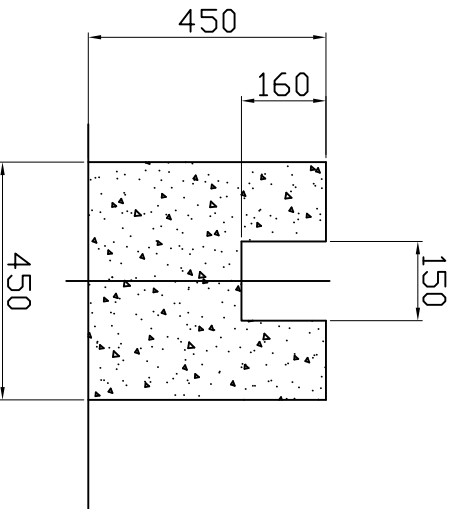
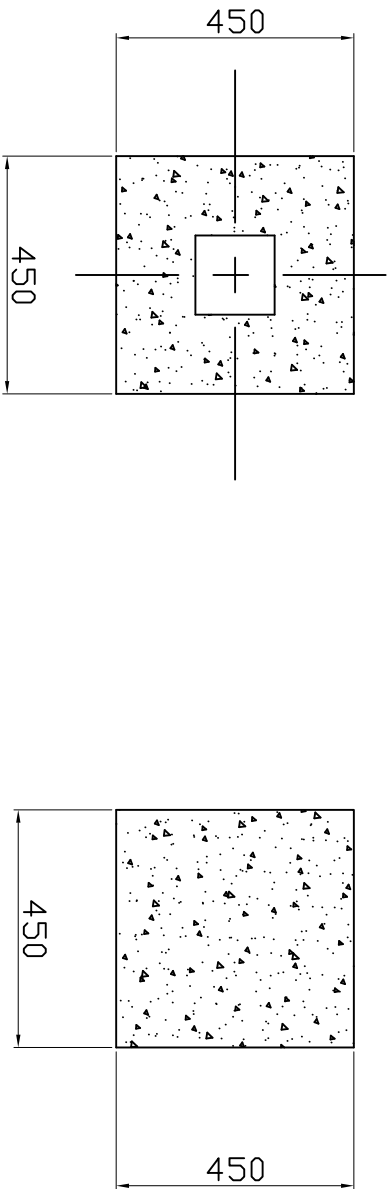

DET. OF MKD.-"X"

DET. OF MKD.-"Y"

NOTES:-

1. ALL DIMENSIONS ARE IN MM.
2. 6 BLOCK WILL BE MADE OF DIMENSION 450 X 450 X 450 HT. CENTRE BLOCK HEIGHT OF DIMENSION 450 X450 X 390 HT.
3. FOUNDATION BOLTS SHALL BE PROVIDED BY PURCHASER. FDN BOLT SIZE 1/2"  $\phi$  X 6" LONG. FOUNDATION PILLARS SHALL BE OF RCC/PCC/BRICK.
4. IN CASE OF MULTIPLE TOWERS, PLEASE MAINTAIN THE DISTANCE OF HALF OF THE COOLING TOWER DIAMETER. THE TOP LEVEL OF EACH SET OF FOUNDATION SHOULD BE ALIGNED AND MATCHED EVENLY.
5. TOP LEVEL OF ALL THE SIDE COLUMNS SHOULD BE MATCHED EQUALLY.
6. IN CASE OF MULTIPLE TOWERS, PLEASE MAINTAIN THE DISTANCE OF HALF OF THE COOLING TOWER DIAMETER. THE TOP LEVEL OF EACH SET OF FOUNDATION SHOULD BE ALIGNED AND MATCHED EVENLY.

SITE:-

DELTA COOLING TOWERS P. LTD.

DES.		TITLE
DRN.	25-6-15	FOUNDATION DRG. OF COOLING
CHKD.		TOWER MODEL NO.5095 / 5096
APPD.		SERIES- DFC 50
SCALE NOT TO SCALE		

JOB NO.

L

M

N

REV-0