

Front View

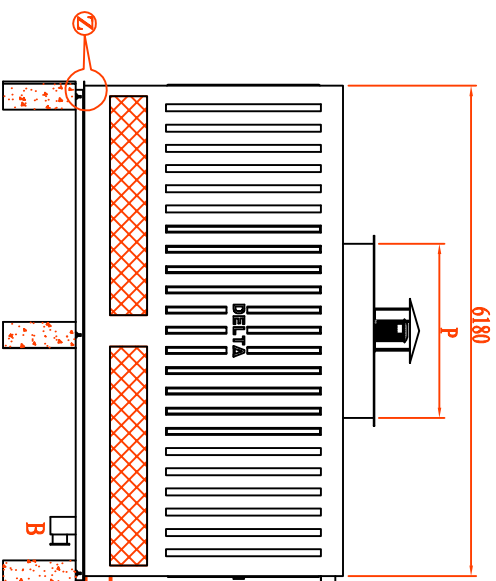

Side View

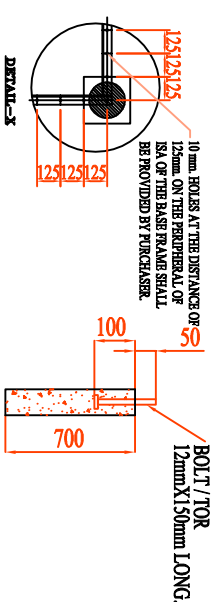

ELEVATION OF PILLER
WITHOUT BOLT OF MKD - "R"
(QTY- 14 NOS.)

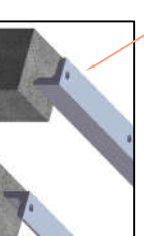

DETAIL - X

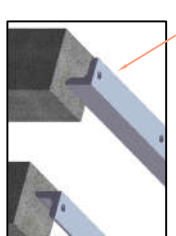

DETAIL - Z

ELEVATION OF PILLER
WITHOUT BOLT OF MKD - "S"
(QTY- 6 NOS.)

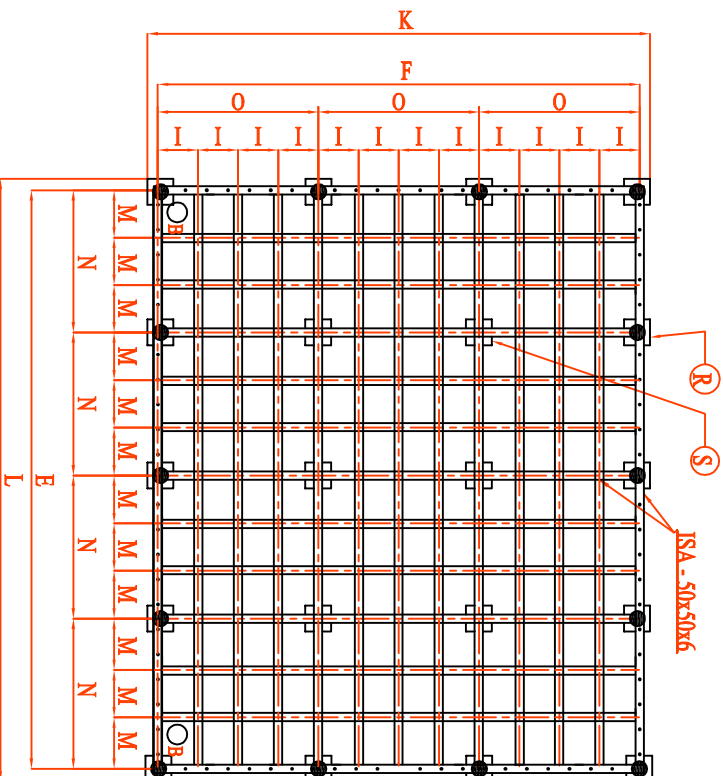

Base Frame

- Notes:-
1. All dimensions are in millimeters.
 2. Cooling tower will be assembled on iso-50x50x6 frame fixed on RCC pillar the frame is under purchasers scope unless otherwise stated.
 3. Makeup and quickfill connection shall be provided with threaded connections as per is-544-1955.
 4. Inlet & outlet connection shall be provided without flange.
 5. RCC basin and RCC pillars 250x250x700 ht. And $\phi 12 \times 150$ long bolts/tor are under purchaser scope.
 6. 10 mm hole at the distance of 125mm on the peripheral of ISA of the base frame shall be provided by purchaser.
 7. Location of outlet connection will be as per the site requirement.
 8. $\phi 12 \times 150$ long bolts/tor shall be grouted in the centre of outer columns as shown in the drawing.
 9. All pictures shown are for illustration purpose only and may differ from the actual cooling tower model.

E	F	K	L	M	I	N	O	P
6480	6180	6430	6730	540	515	1620	2060	2400

DESCRIPTION	MARK	SIZES
INLET PIPE CONNECTION	A	150 X 4 NOS.
OUTLET PIPE CONNECTION	B	200 X 2 NOS.
DRAIN & OVERFLOW CONNECTION	C	65 EACH
MAKEUP AND QUICKFILL CONNECTION	D	40 EACH
LENGTH OF COOLING TOWER	E	6480
WIDTH OF COOLING TOWER	F	6180
FAN DIA AND NOS.	P	$\phi 2400 \times 2$ Nos.
OPERATING WEIGHT (KG.)		12500

NOT TO SCALE / DO NOT SCALE DRAWING	DWG NO.:-
TITLE:- G.A OF DRG. OF COOLING TOWER MODEL NO. 6800 SERIES - DPC 60	
COMPANY:- Delta Cooling Towers P. Ltd Delhi (PH - 011-27493801/02/03) EMAIL - info@delta.cool	
SITE:-	
DesignOnConnect.com	REV :- 12/2017