

Front View

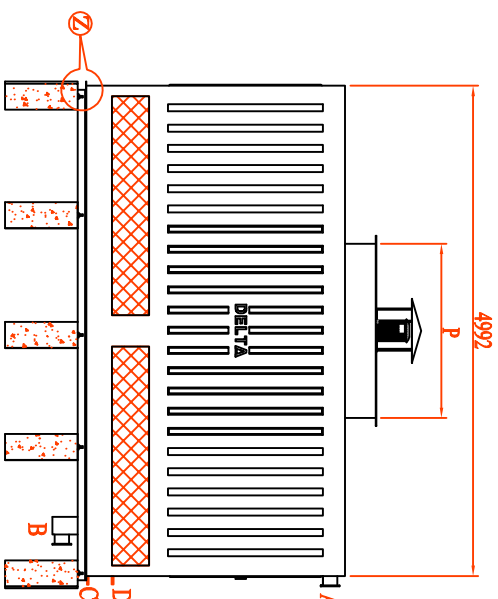

Side View

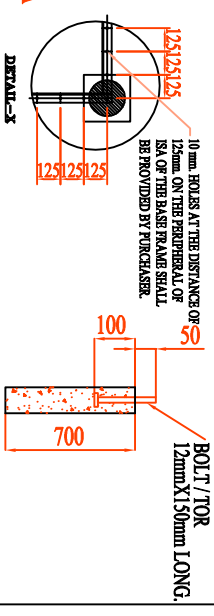

ELEVATION OF PILLER  
WITHOUT BOLT OF MKD - "R"  
(QTY- 16 NOS.)

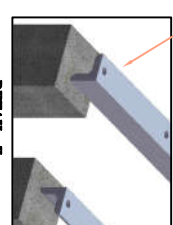

ALL PERIPHERAL ISA (ANGLES) SHALL BE  
FACED OUTSIDE.

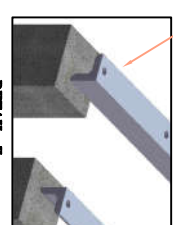

ELEVATION OF PILLER  
WITHOUT BOLT OF MKD - "S"  
(QTY- 9 NOS.)

Notes:-

1. All dimensions are in millimeters.
2. Cooling tower will be assembled on ISA-50x50x6 frame fixed on RCC pillar the frame is under purchasers scope unless otherwise stated.
3. Makeup and quickfill connection shall be provided with thread connections as per is-544-1955.
4. Inlet & outlet connection shall be provided without flange.
5. RCC basin and RCC pillars 250x250x700 ht. And  $\phi 12 \times 150$  long bolts/tor are under purchaser scope.
6. 10 mm hole at the distance of 125mm on the peripheral of ISA of the base frame shall be provided by purchaser.
7. Location of outlet connection will be as per the site requirement.
8.  $\phi 12 \times 150$  long bolts/tor shall be grouted in the centre of outer columns as shown in the drawing.
9. All pictures shown are for illustration purpose only and may differ from the actual cooling tower model.

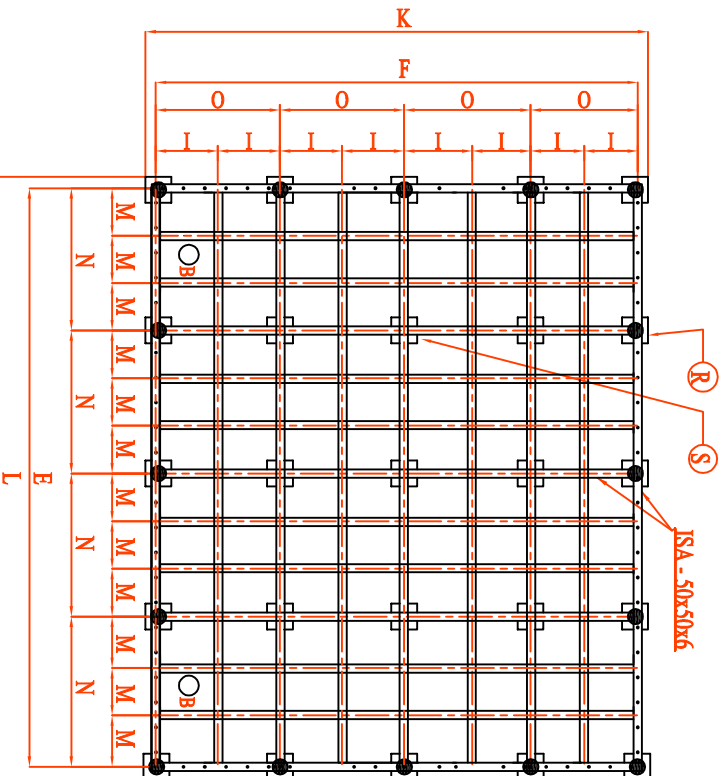

Base Frame

E	F	K	L	M	I	N	O	P
6160	4992	5242	6410	514	624	1540	1248	2100

DESCRIPTION	MARK	SIZES
INLET PIPE CONNECTION	A	150 X 4 NOS.
OUTLET PIPE CONNECTION	B	200 X 2 NOS.
DRAIN & OVERFLOW CONNECTION	C	65 EACH
MAKEUP AND QUICKFILL CONNECTION	D	40 EACH
LENGTH OF COOLING TOWER	E	6160
WIDTH OF COOLING TOWER	F	4992
FAN DIA AND NOS.	P	$\phi 2100 \times 2$ Nos.
OPERATING WEIGHT (KG.)		9500

NOT TO SCALE / DO NOT SCALE DRAWING	JOB NO.-
TITLE: G.A OF DRG. OF COOLING TOWER MODEL NO. 6600 SERIES - DPC 60	
COMPANY: Delta Cooling Towers P. Ltd Delhi (PH. 011-27493801/02/03) EMAIL- <a href="mailto:info@delta.coil">info@delta.coil</a>	
SITE:	
DesignOnComputer.com	REV :- 12/2017